



Ratings	50 Hz	
	kW	kVA
Prime	88	100
Standby	80	110

Engine	Prime rating
Engine manufacturer	Cummins
Engine model	F3.8
Configuration	4 Cycle; In-line; 4 Cylinder Diesel
Aspiration	Turbocharged
Gross engine power output, kWm	82
Bore, mm	102
Stroke, mm	115
Rated speed, rpm	1500
Compression ratio	
Lube oil capacity, L	13
Governor type	ECU
Starting voltage	12 Volts DC
Emission Level Compliance	EU Stage V

Alternator	
Alternator Manufacturer	Stamford
Alternator Model	UC1274D
Rating continuous (50 Hz - kVA)	100
Excitation system STD/OPT	PMG - MX341/ D550
Impregnation	
IP rating	23

Fuel Tank	
Standard tank capacity (L)	176
Standard tank autonomy @ 75 % load - Prime (Hours)	11
Extended tank capacity (L)	386
Extended tank autonomy @ 75 % load - Prime (Hours)	23.5

Fuel Consumption	
Prime 0% L/h	2.8
Prime 50% L/h	11.9
Prime 75% L/h	16.5
Prime 100% L/h	21.8

Electrical

Battery type	1x12V
Battery Capacity (Ah)	120
Battery Cold Cranking Amps	700
Main circuit breaker - Brand	Schneider
Main circuit breaker - Type	Manual 4P
Main circuit breaker - Amps	160

Control Panel

	STD	OPT
Brand	COMAP	DEIF
Reference	MRS16	AGC150
		Synchro

Cooling

Fan load, KW _m	1.8
Coolant capacity (with radiator), L	23
Cooling system air flow, m3/sec @ 12.7mmH2O	
Limited Ambient Temperature	51

Weights*

	Standard fuel tank	Extended fuel tank
Unit dry weight kgs	1895	1944
Unit wet weight kgs	2061	2292

* Weights represent a set with standard features.

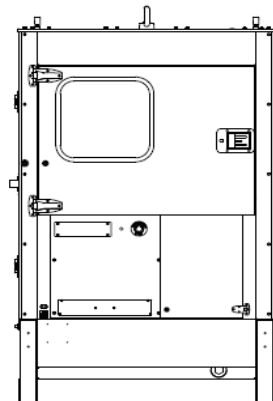
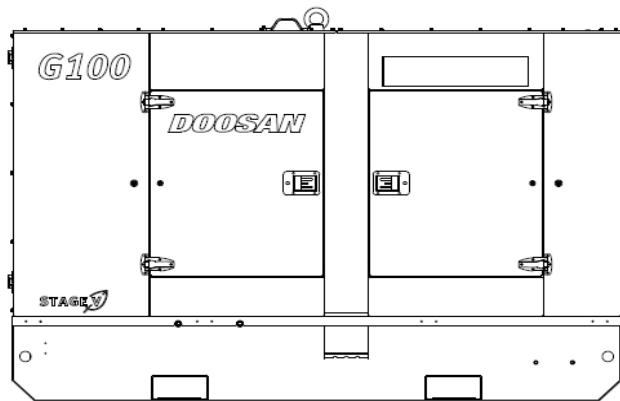
**Dimensions**

	Length	Width	Height
Standard dimensions (without option)	2709	1120	1999
Rubber protection option	2759	1160	
Extended fuel tank			2099
	Inside dist	Outside dist	Height
Forklift pockets (mm)	980	1460	106

Noise

Measured LWA	91
Average Noise level @ 1m @ 75 % load dB(A)	74
Average Noise level @ 7m @ 75 % load dB(A)	64